

Directions to St. Bonaventure University

From the Buffalo Airport (From other locations, see last page.)

Total Estimated Distance: 78.1 mi

Total Estimated Time: 1 hour 28 mins

- | | | |
|---|---|-----------------------------|
| | 1. Head southwest toward Cayuga Rd/Genesee St
About 1 min | go 0.4 mi
total 0.4 mi |
|  | 2. Continue straight onto NY-33 W/Kensington Expy
About 2 mins | go 1.6 mi
total 2.0 mi |
|  | 3. Take the exit onto I-90 W
About 7 mins | go 7.5 mi
total 9.5 mi |
|  | 4. Slight right onto US-219 S (signs for Orchard Park/Springville)
About 26 mins | go 28.4 mi
total 37.9 mi |
|  | 5. Turn right onto US-219 S/Peters Rd | go 0.3 mi
total 38.2 mi |
|  | 6. Turn left onto US-219 S
About 15 mins | go 13.7 mi
total 51.9 mi |
|  | 7. Turn right onto NY-242 W/US-219 S
About 2 mins | go 1.0 mi
total 52.9 mi |
|  | 8. Turn left at the 2nd cross street onto US-219 S/Jefferson St
Continue to follow US-219 S
About 7 mins | go 4.8 mi
total 57.7 mi |
|  | 9. Turn right to stay on US-219 S
About 7 mins | go 5.3 mi
total 63.0 mi |
|  | 10. Turn left onto NY-417 E/US-219 BUS S/Wildwood Ave
Continue to follow NY-417 E
About 19 mins | go 14.9 mi
total 77.8 mi |
|  | 11. Turn right onto College St
Destination will be on the left
About 1 min | go 0.3 mi
total 78.1 mi |

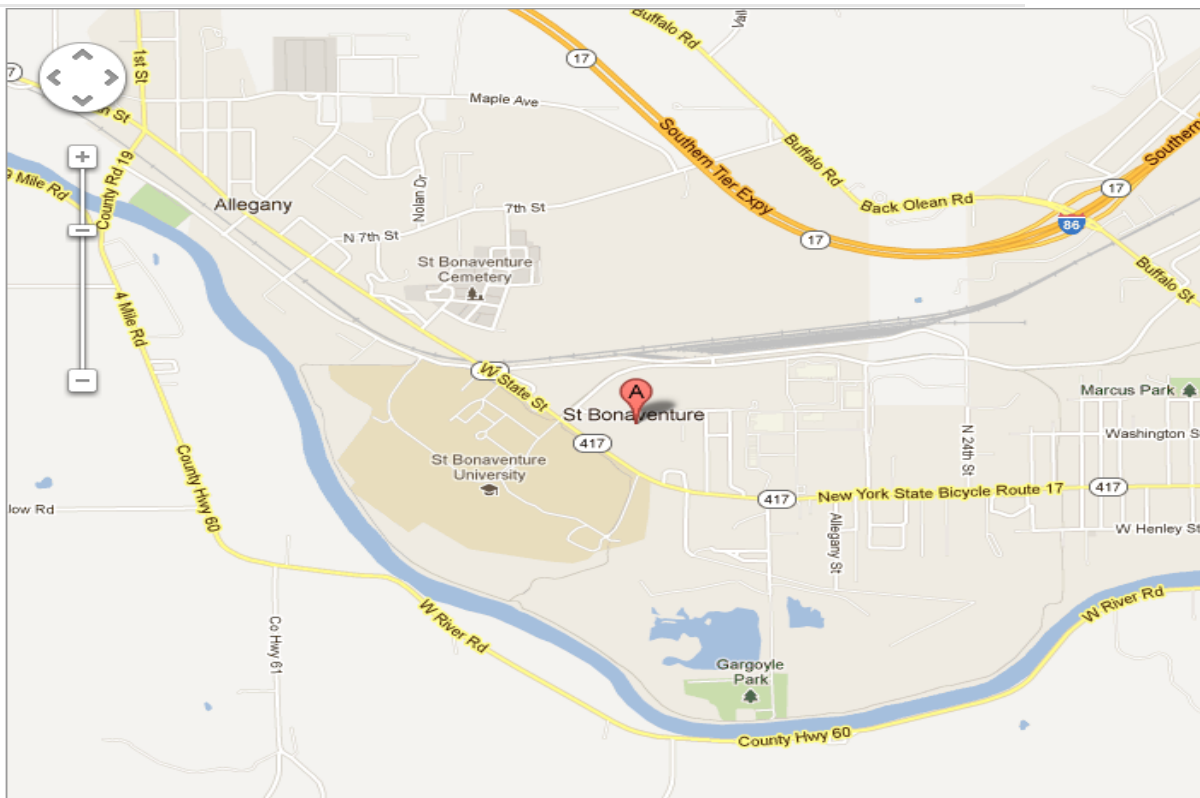

Directions to the Career & Professional Readiness Center (CPRC), via the Main Entrance

At the first stop sign, continue STRAIGHT. At the next stop sign, go STRAIGHT.

The Reilly Center will be on your right, just after the Richter Fitness Center.
Park in the parking lot behind the Reilly Center.

Facing the back of the building, enter through the set of doors on the far left side.



Enter at traffic light

Directions to the CPRC, inside Reilly Center

First Floor, Reilly Center

Far Left

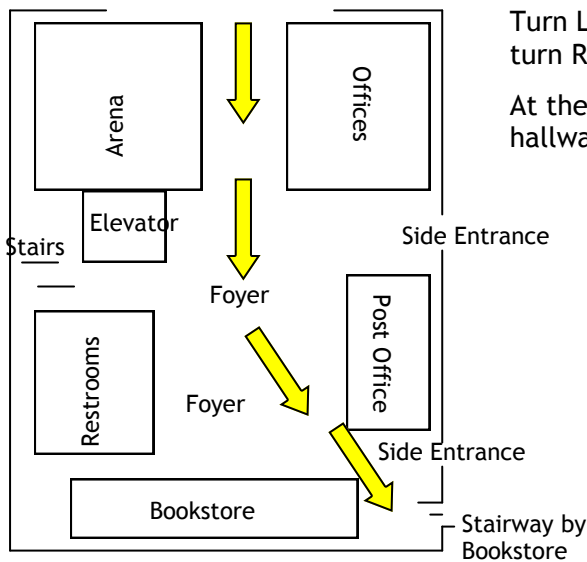

Follow the hallway straight through the building. You will pass the Post Office on your left and come to the Book Store directly ahead of

Turn LEFT. Before going through the double doors that lead outside, turn RIGHT to go up the stairs to the second floor.

At the top of the stairs, go LEFT, and then go STRAIGHT down the hallway. Find us in Room 231. Welcome!

Stairway by Bookstore

Second Floor, Reilly Center

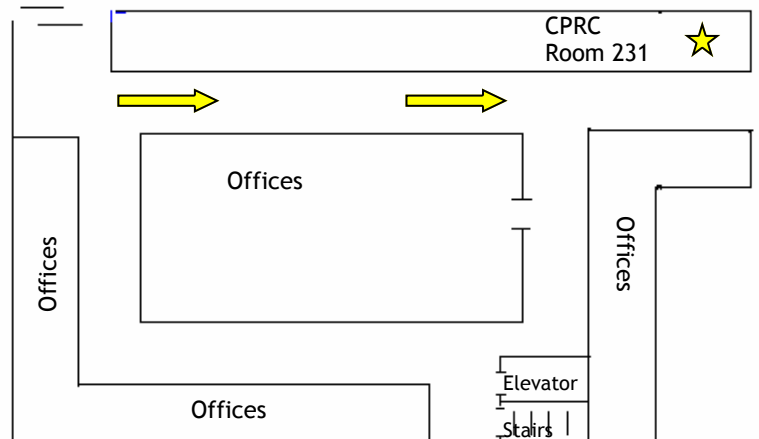

Directions to St. Bonaventure University (From other locations)

Please enter the campus using the main entrance at the traffic light.



From Buffalo: 1 hour, 45 minutes

South on Route 219 to Salamanca, then east on Interstate 86 (formerly Route 17) to exit 24; or south on Route 400, then south on Route 16 to Route 417 West.

From New York: 6 hours

Across the George Washington Bridge to I-80 West. Stay on I-80 West until Route 380 West, then go north on Route I-81 to Interstate 86 (formerly Route 17). Go west on I-86 to exit 24.

From Pittsburgh: 4 hours

North on Route 79 to Route I-80, then east on Route I-80 to Route 219. Take Route 219 North to Interstate 86 (formerly Route 17), then go east on I-86 to exit 24.

From Rochester: 2 hours, 15 minutes

South on Route I-390 to Dansville, then take Route 36 South to Arkport. Take Interstate 86 (formerly Route 17) West to exit 24.

From Syracuse and Utica: 4 hours

West on Route I-90 (N.Y.S. Thruway) to Geneva, N.Y., then south on Route 14 to Route 54. Take Route 54 South to Interstate 86 (formerly Route 17), then go west to exit 24.

From Albany: 5 hours

West on Route I-90 (N.Y.S. Thruway) to Route 88 South (Binghamton), then take Interstate 86 (formerly Route 17) West to exit 24.

From New Jersey: 5.5 hours

Take Route I-80 West to Route 380 West to Scranton, Pa. Pick up Route I-81 North to Binghamton, N.Y., then take Interstate 86 (formerly Route 17) West to exit 24.

From Philadelphia: 6.5 hours

Take NE Extension (Route 9) of Pa. Turnpike to the last exit at Scranton, Pa., then pick up Route I-81 North to Binghamton, N.Y. Take Interstate 86 (formerly Route 17) West to exit 24.

From Erie, Pa.: 1.5 hours

East on Route I-90 to Interstate 86 (formerly Route 17), then east on I-86 to exit 24.

From Cleveland, Ohio: 3.5 hours

East on Route I-90 to Route 17 (I-86), then east on Route 17 (I-86) to exit 24.

From Danbury, Conn.: 6 hours

West on Route I-84 toward Brewster, N.Y., then take Interstate 86 (formerly Route 17) West to exit 24.

From Washington, D.C.: 6 hours

Take Route 270 North to Route 15. Follow Route 15 North to Corning, N.Y., then pick up Interstate 86 (formerly Route 17) West to exit 24.

From Toronto, Canada: 3.5 hours

Take the QEW to Buffalo, N.Y., then I-190 to I-90 (Thruway) to Route 219 South. Follow Route 219 to Salamanca, then take I-86 East toward Olean. Take Exit 24 in Allegany, turn left (east) onto Route 417, go through the village of Allegany, then approximately another mile to the University entrance.